

Gripper

AF101-10,10N,12

Character

- Rack & pinion type
- High gripping forces by the structure of synchronized dual piston
- Magnetic sensor is available for open-close sensing
- AF101-10 is old model (sensor is not available)

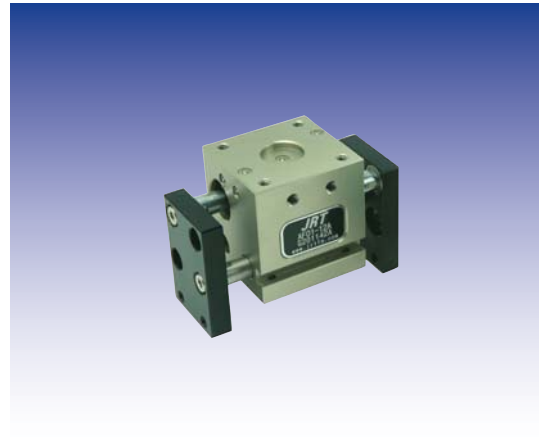

Rack & pinion type

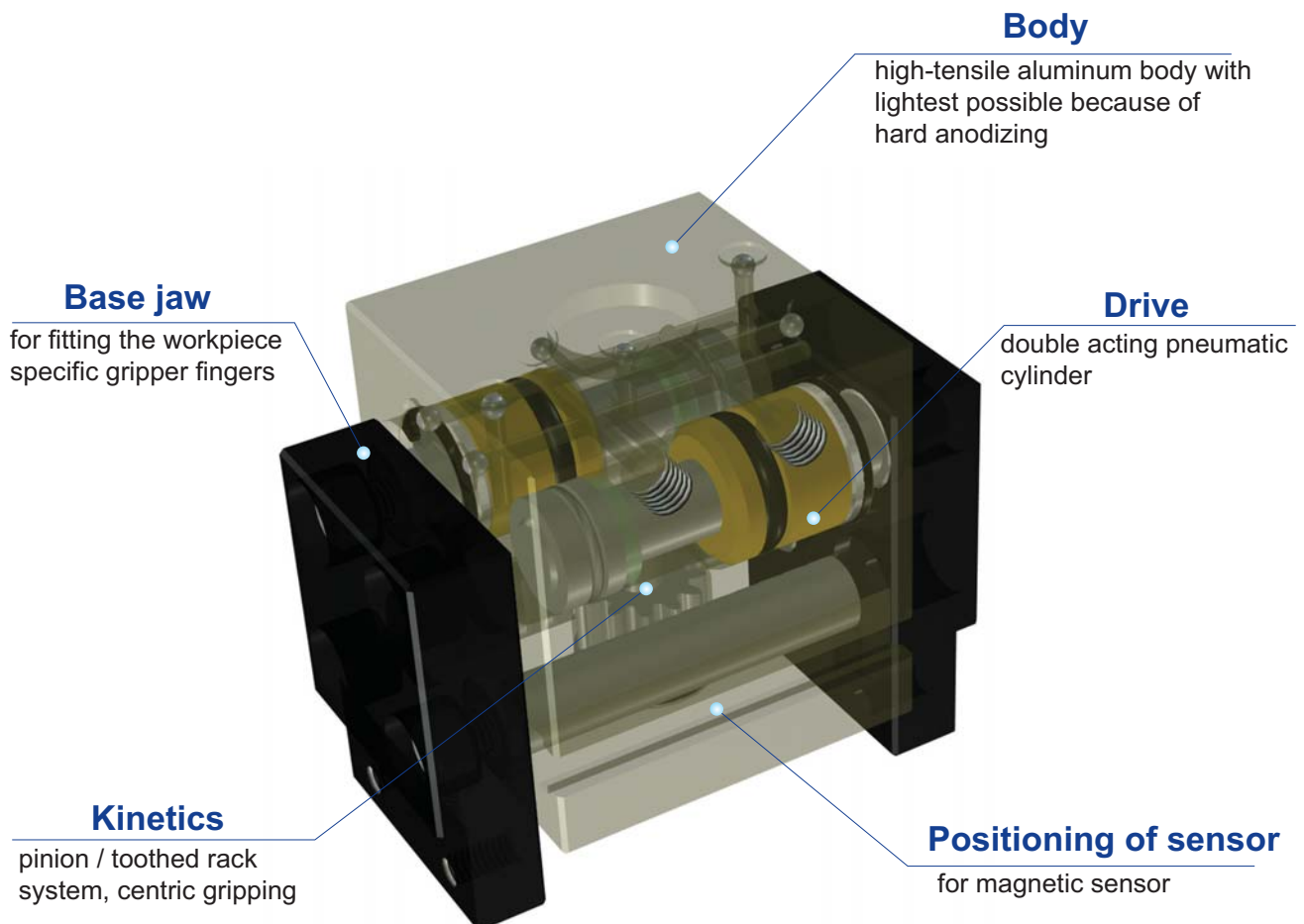

AF101

Exploded view

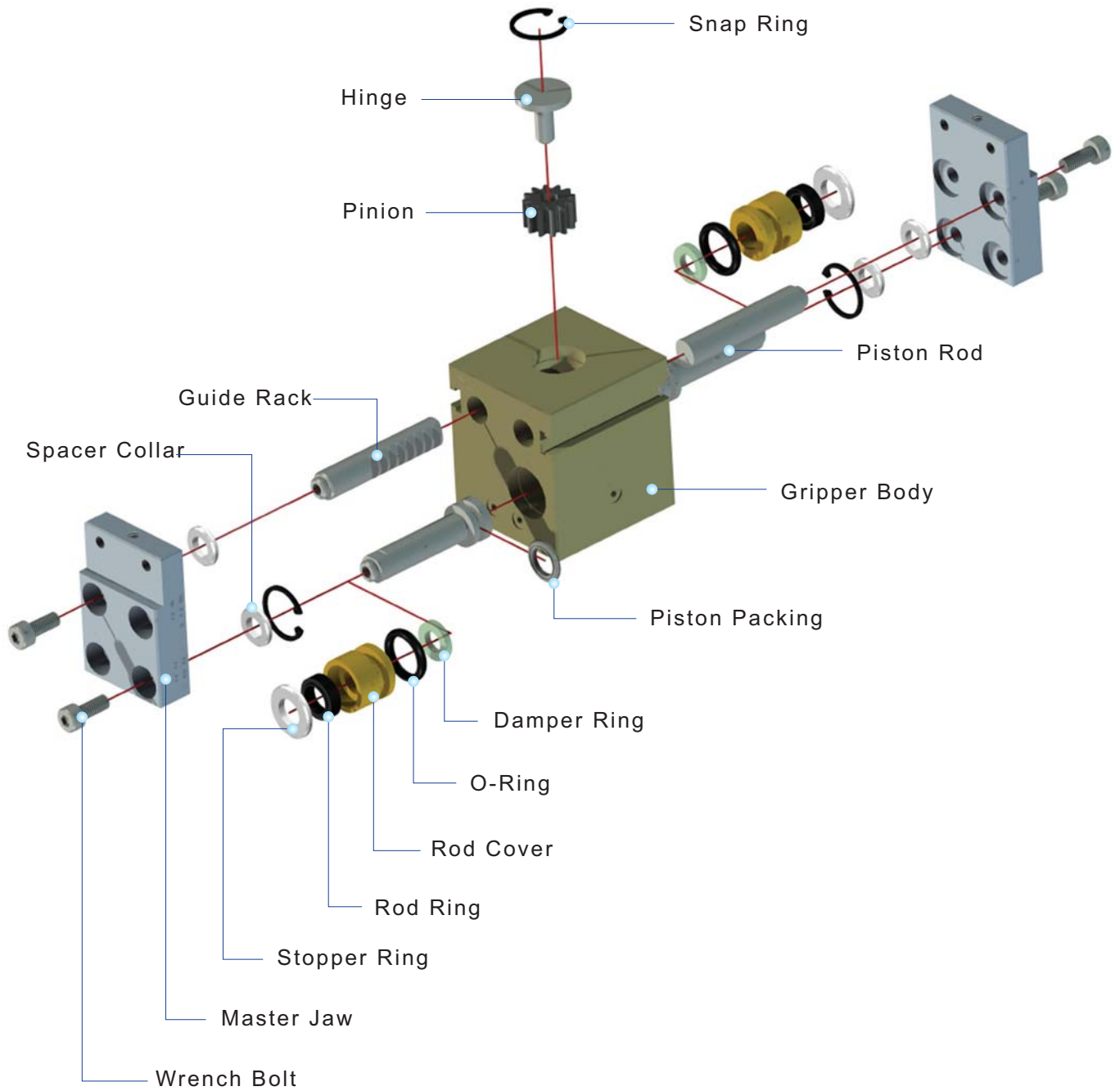

AF101

Ordering Code

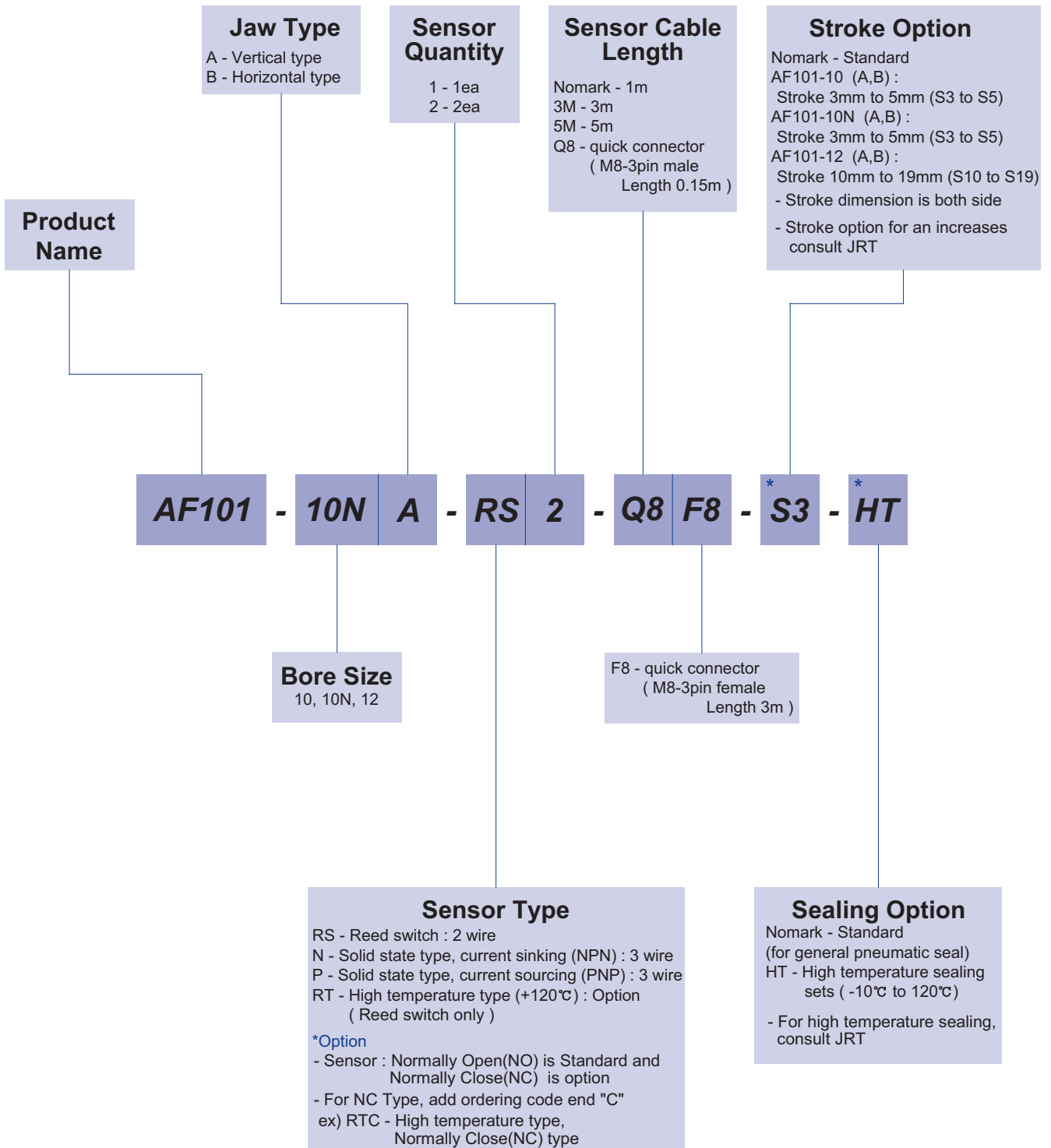

The delivery of * mark option is longer than a standard, So inquire of JRT

AF101

Specification

P=Air Pressure[bar] , L=Exertion length[mm]

Products Name	AF101-10N	AF101-12	Unit
Stroke	6	20	mm
Weight	0.14	0.29	kg
Max. length of attach	20	30	mm
Fitting size	M5	M5	
Gripping force:Open	$7.85P/(1+0.013L)$	$12.75P/(1+0.01L)$	N
Gripping force:Close	$4.91P/(1+0.013L)$	$6.86P/(1+0.01L)$	N
Air consumption per cycle	0.8	3.5	cm ³
Closing / Opening time	0.01 / 0.01	0.01 / 0.01	sec
* Repeat accuracy	0.01	0.01	mm
Max.cycle per minute	60	60	
Operating pressure	3~7		bar
Ambient temperature	-5 to 60		°C
Lubrication	Needless		

* After 100 consecutive strokes to end positions

Gripping Force per exertion length

Legend : ■ 7[bar] ■ 5[bar] ■ 3[bar]

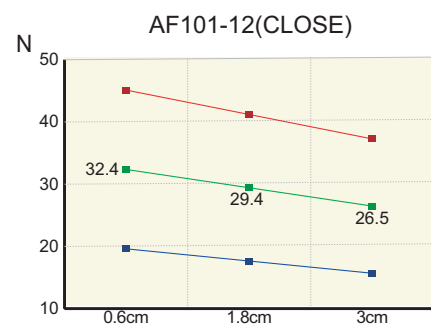
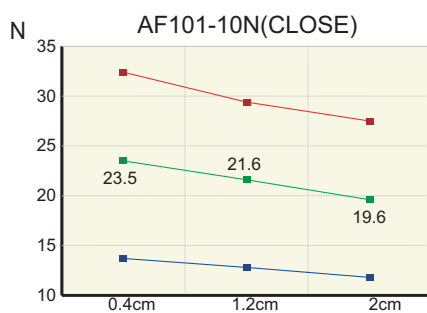
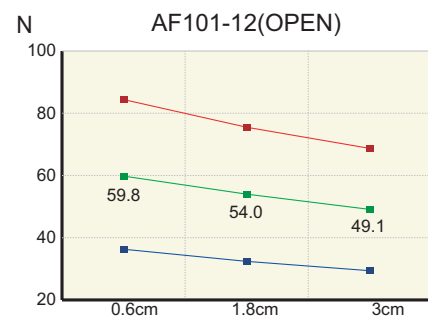
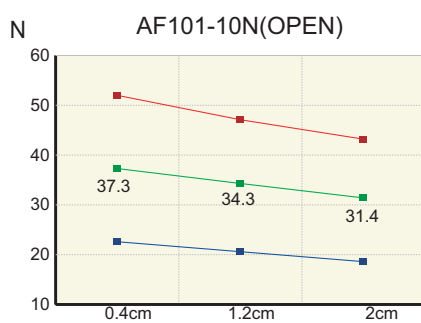

AF101

AF101-10NA

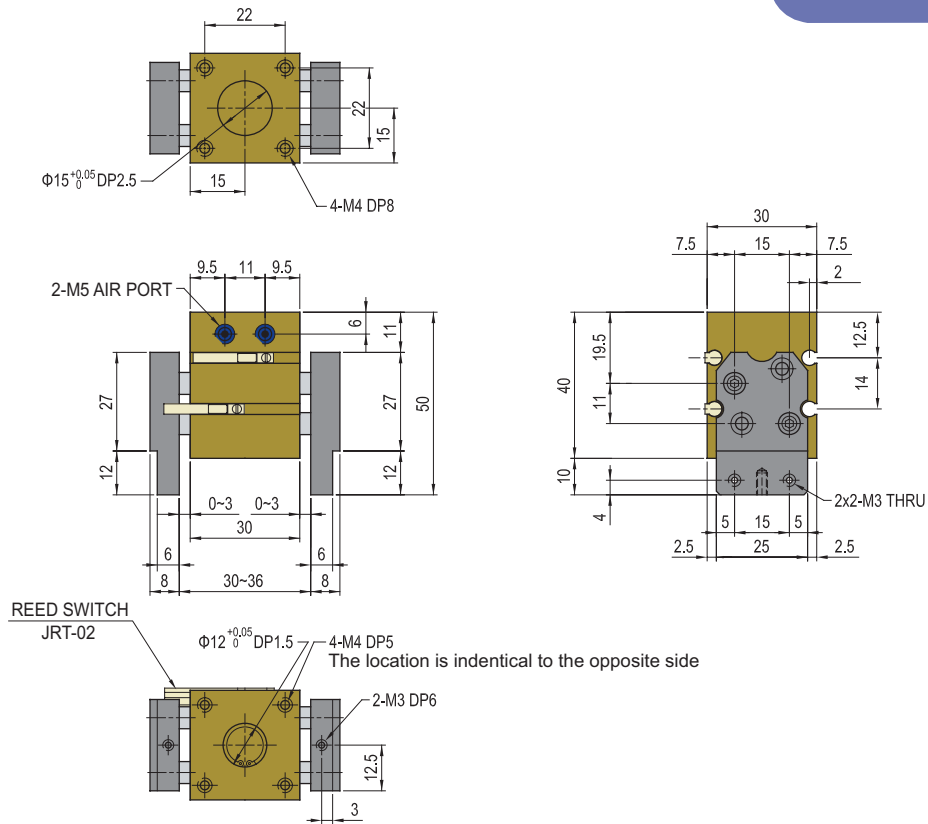

AF101-10NB

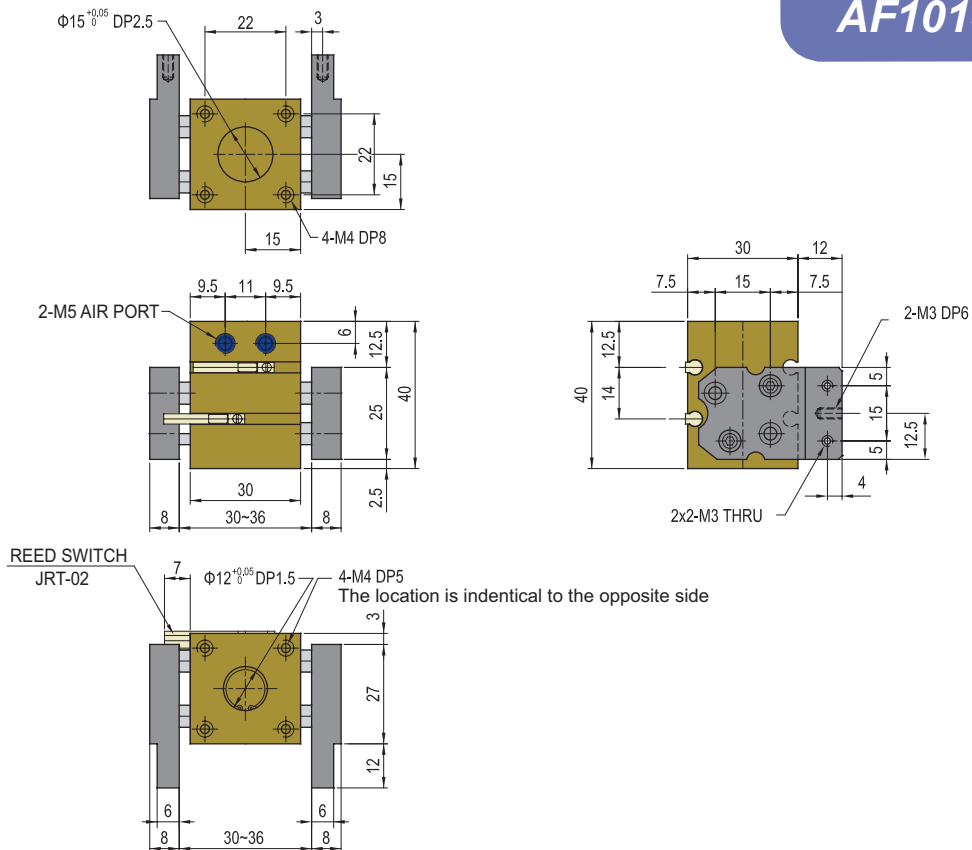

AF101

AF101-12A

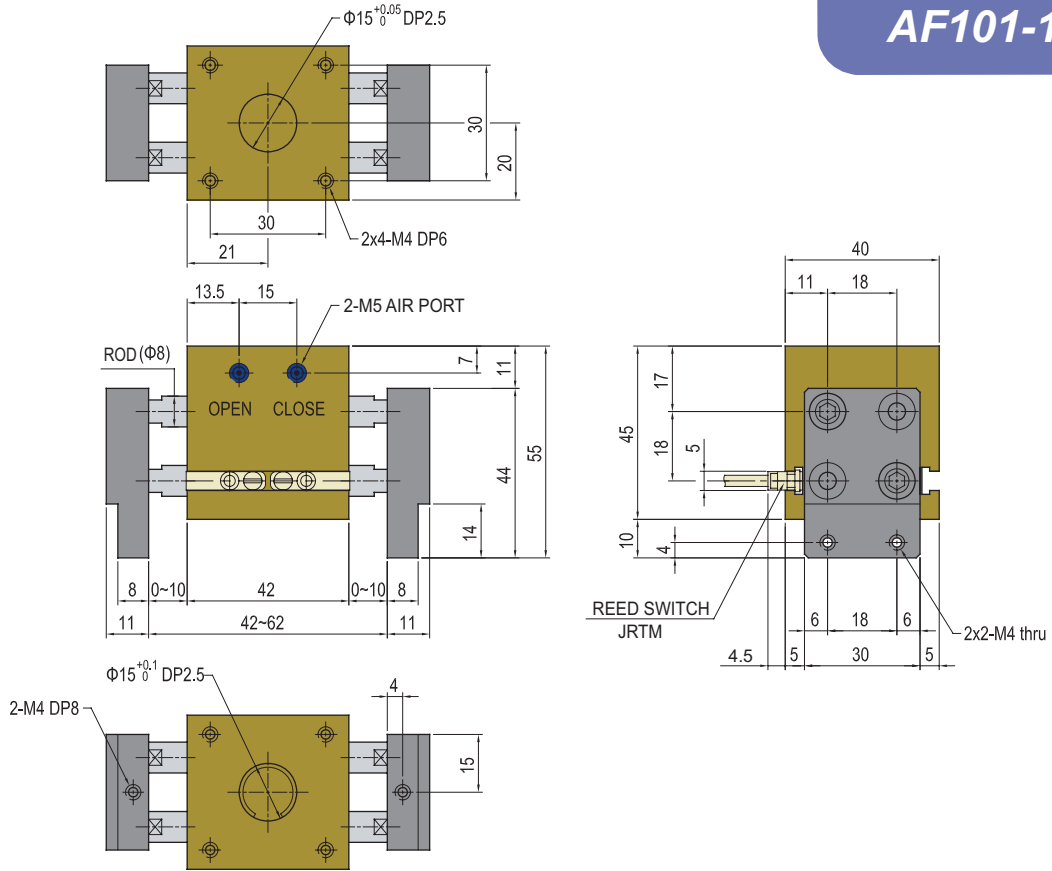

AF101-12B

