

Gripper

AF105P-08,10,16

Character

- Back pressure sensor is available only.
- Small size but strong grip force
- Taper sliding & roller guide type
- Easy to mount many grippers (compact body)

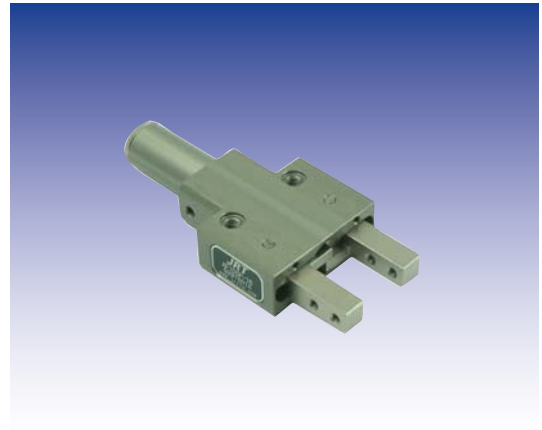

Roller guide type

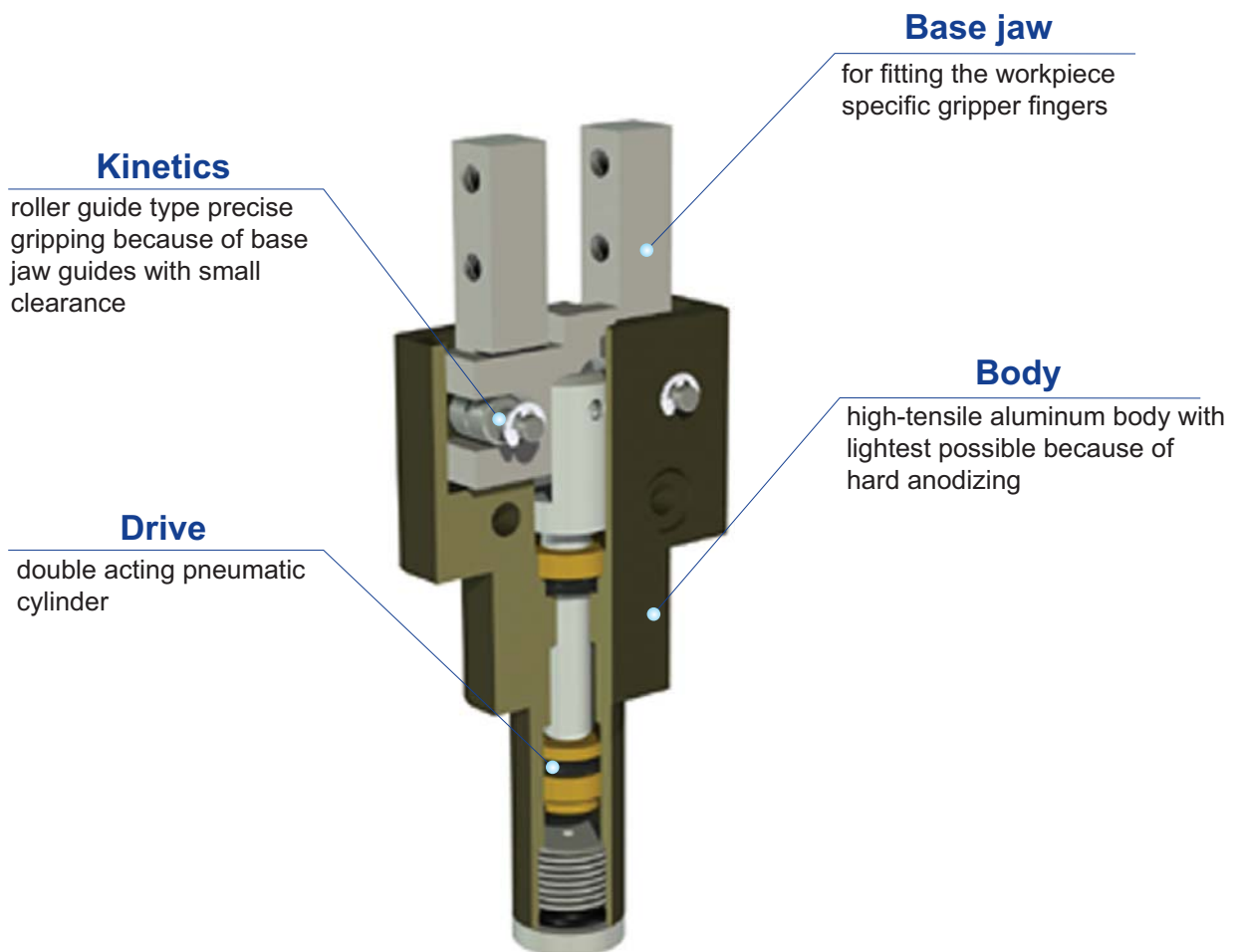

AF105P

Exploded view

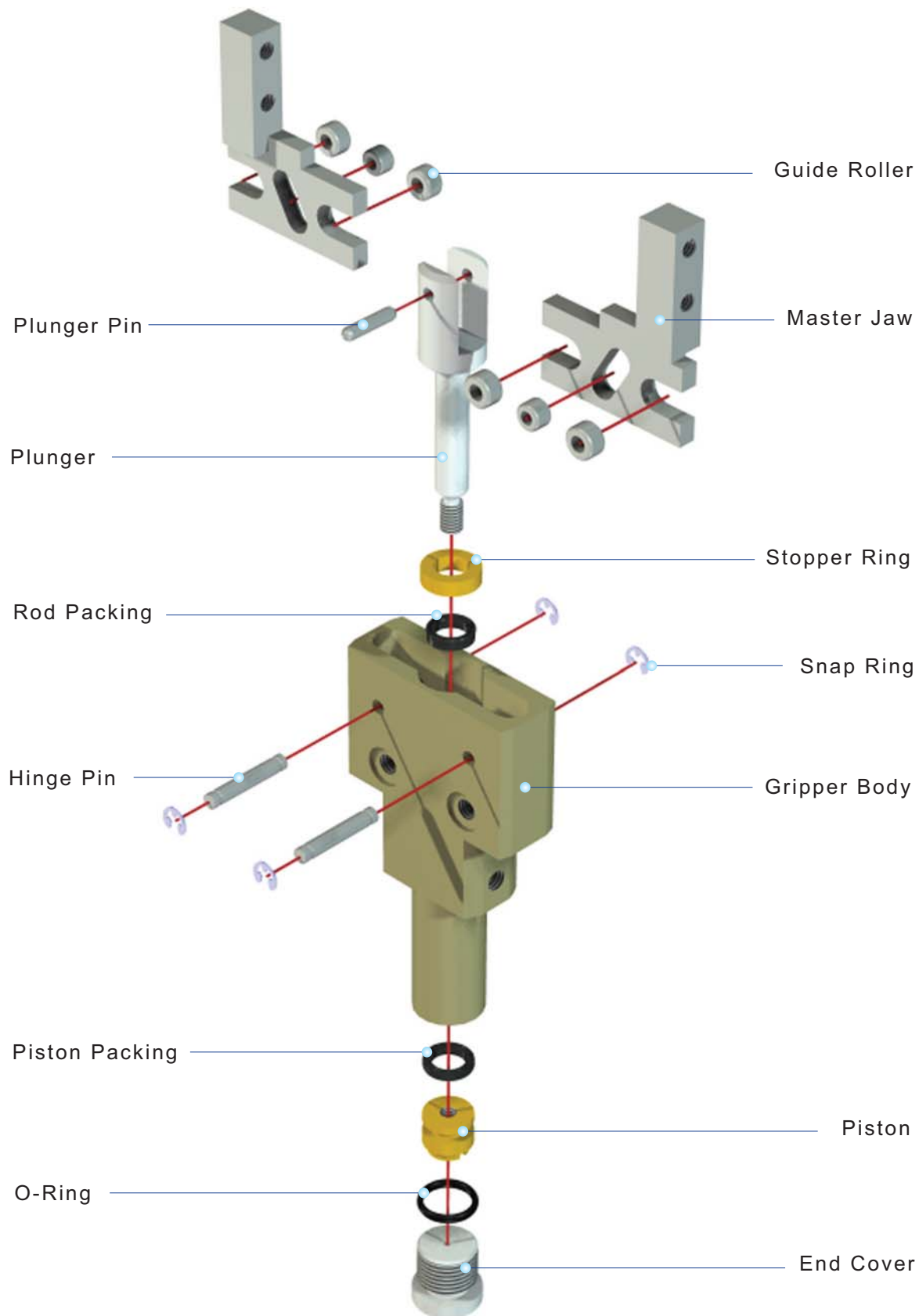

AF105P

Ordering Code

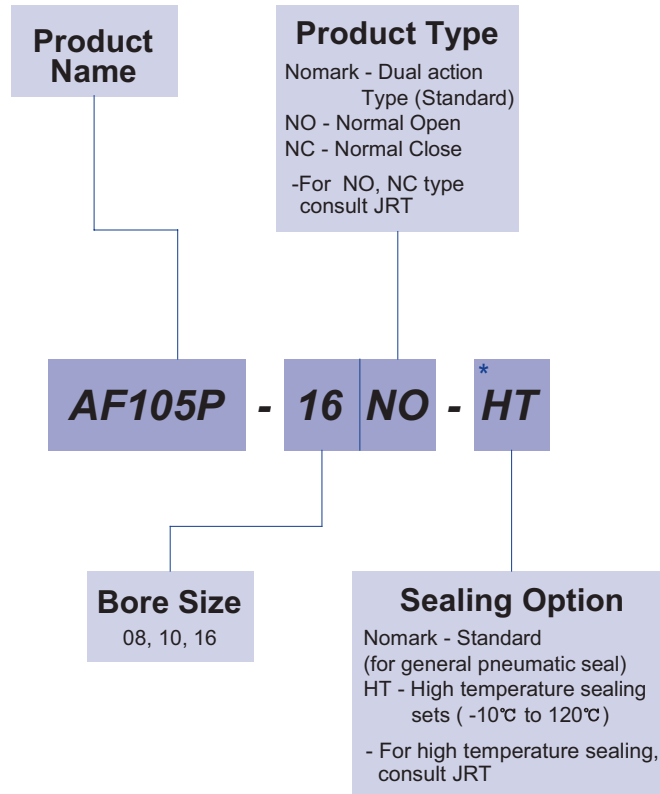

This product sensor is only back pressure sensor

*The delivery of * mark option is longer than a standard, So inquire of JRT*

AF105P

Specification

P=Air Pressure[bar] , L=Exertion length[mm]

Products Name	AF105P-8	AF105P-10	AF105P-16	Unit
Stroke	4	5	8	mm
Weight	0.06	0.11	0.27	kg
Max. length of attach	25	30	40	mm
Fitting size	M5	M5	M5	
Gripping force:Open	2.45(P-0.015L)	3.34(P-0.015L)	9.81(P-0.015L)	N
Gripping force:Close	3.43(P-0.015L)	5.40(P-0.015L)	12.26(P-0.015L)	N
Air consumption per cycle	0.2	0.3	1.4	cm ³
Closing / Opening time	0.01 / 0.01	0.01 / 0.01	0.01 / 0.01	sec
* Repeat accuracy	0.01	0.01	0.01	mm
Max.cycle per minute	60	60	60	
Operating pressure	3~7			bar
Ambient temperature	-5 to 60			°C
Lubrication	Needless			

* After 100 consecutive strokes to end positions

Gripping Force per exertion length

Legend : ■ 7[bar] ■ 5[bar] ■ 3[bar]

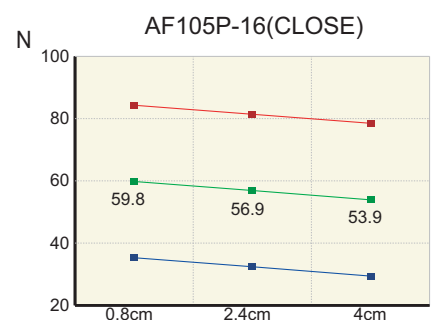
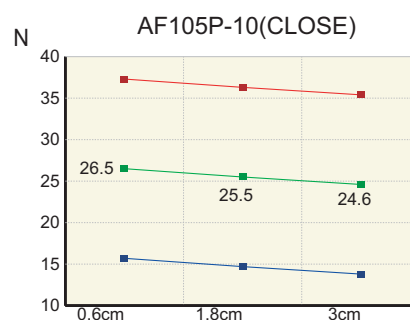
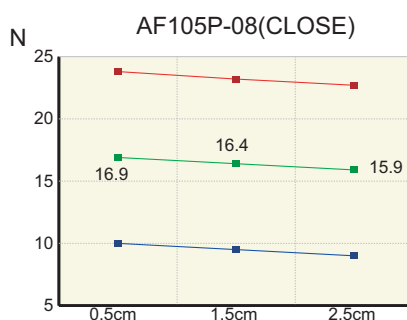
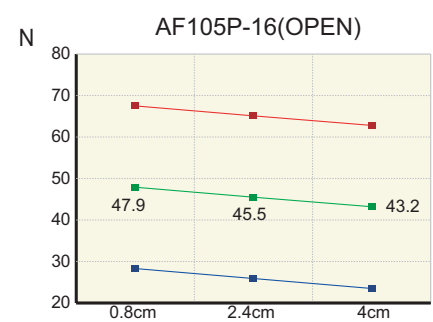
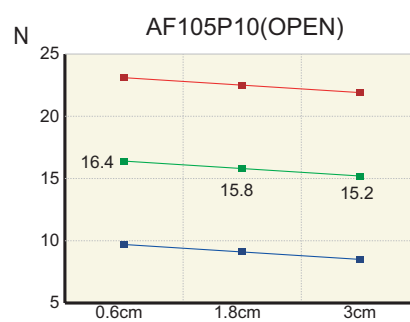
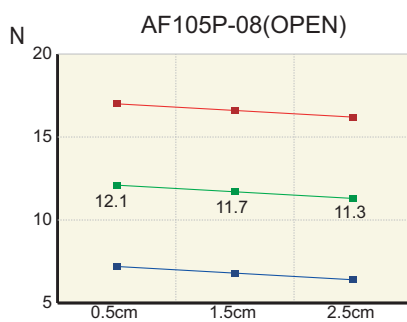

AF105P

AF105P-08

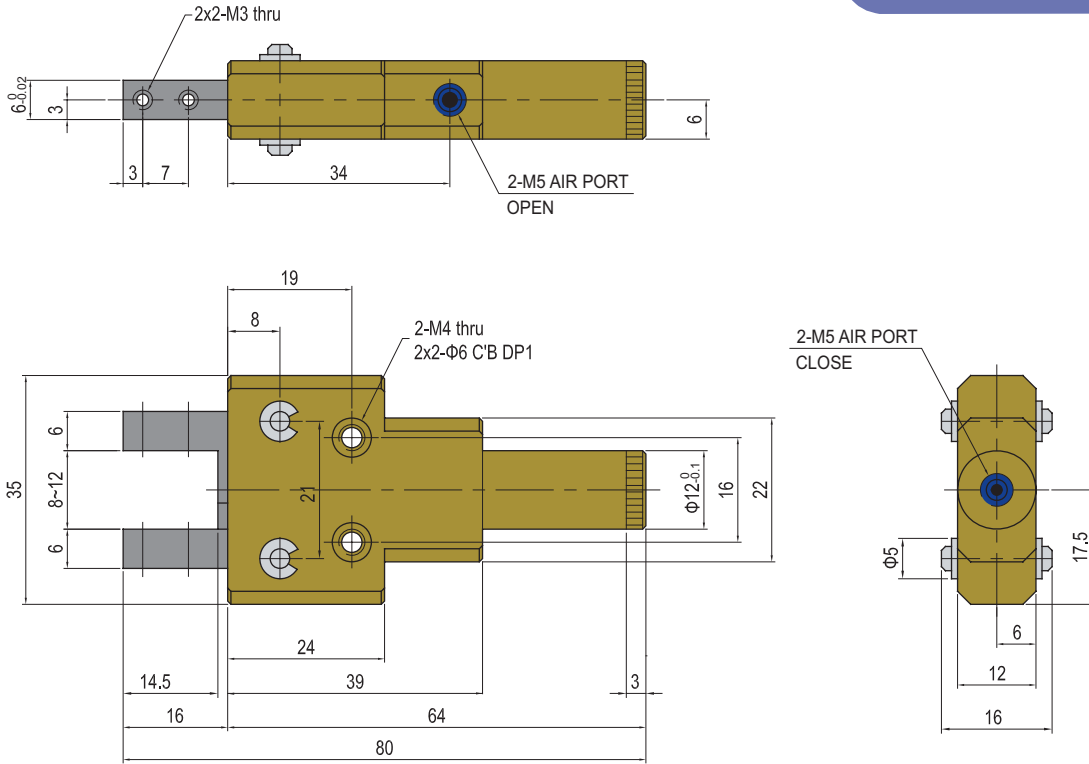

AF105P-10

