

Metric Size R(PT) Thread Type

- One -Touch Fittings
- Compact One -Touch Fittings
- Speed Controllers
- Metal Body Speed Controllers
- Rotary Joints
- Stop Fittings**
- Check Valves
- Ball Valves
- Main Blocks
- Hand Valves
- Hand Slide Valves
- Two-Touch Fittings

STOP FITTINGS

Application

- Installed where the pneumatic connections are changed frequently.
- Used at laboratory or for instructing pneumatic connections.

Feature

- Upon disconnecting the tube, the airflow will stop.

Specification

Fluid	Air(No other gases or liquids)	
Working Pressure Range	0~150PSI	0~9Kgf/cm ² (0~900kPa)
Negative Pressure	-29.50 in Hg	-750mmHg(10Torr)
Temperature Range	32~140° F	0~60° C
Applicable Tube Material	Polyurethane and Nylon	

Structural Diagram

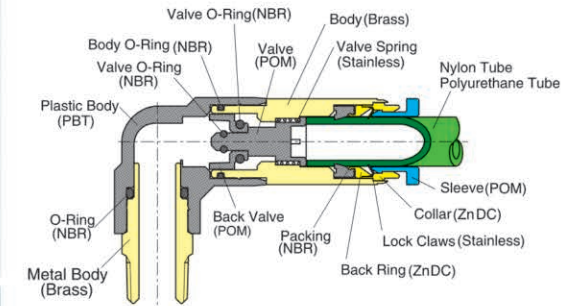

Control Method

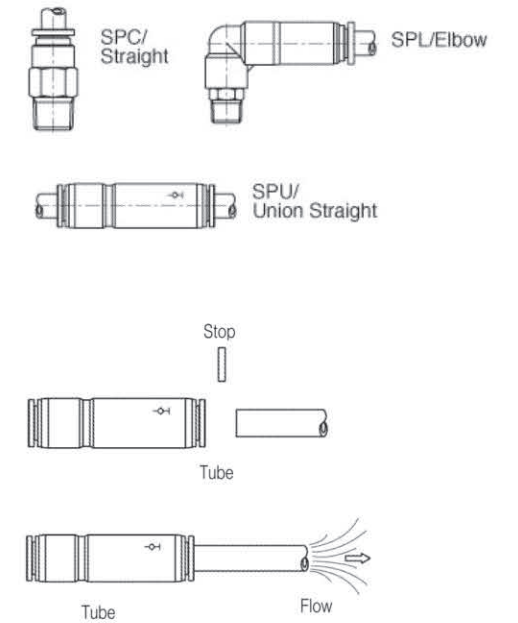

Product Code System

SPC O6-O1

	①	②	③			
① Type						
② Tube Dia(∅D)	Code	04	06	08	10	12
	Dia	∅4	∅6	∅8	∅10	∅12
③ Thread Size(T)		Metric Size		Taper Pipe Thread		
	Code	M5	M6	01	02	03
	Size	M5 × 0.8	M6 × 1.0	R1/8	R1/4	R3/8
						R1/2

CAUTION

- Be sure to read the "Common Precautions" and "Using Precautions of Fitting Series"(P12) before using.
- Be sure to confirm the direction of the stop instrument.

WARNING

- Be careful of spring-up of the tube in case of disconnection when the pressure is on in the stop fitting.

SPC
Straight

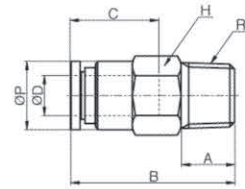

MODEL[ØD-T] Tube(Metric)-Thread(R)

MODEL	ØD	R	H	C	ØP	B	A	W.G(g)	Qty/Inbox
SPC 04-01	4	R1/8	10	16	10	25.5	8	10.5	100
SPC 06-01	6	R1/8	12	17	12	27.8	8	12.7	100
SPC 06-02	6	R1/4	14	17	13	27.8	11	21.3	50
SPC 08-01	8	R1/8	14	18.5	14	31.8	8	24	50
SPC 08-02	8	R1/4	14	18.5	14	31.8	11	20.4	50
SPC 08-03	8	R3/8	17	18.5	17	31.8	12	38.7	50
SPC 10-02	10	R1/4	17	21	17	36.1	11	29.4	50
SPC 10-03	10	R3/8	17	21	17	36.1	12	34.3	50
SPC 10-04	10	R1/2	21	21	18	36.1	15	61	50
SPC 12-03	12	R3/8	21	22	20.2	44.2	12	58.8	25
SPC 12-04	12	R1/2	21	22	20.2	44.2	15	66.9	25

SPUM
Elbow

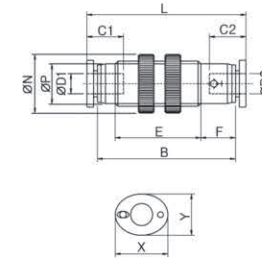

MODEL[ØD-T] Tube(Metric)-Thread(R)

MODEL	ØD1	ØD2	ØP	C1	C2	F	B	L	ØN	X	Y	W.G(g)	Qty/Inbox
SPUM 04	4	4	10.4	16	16	9.4	37.4	43.2	17	10	12	7.4	50
SPUM 06	6	6	12.4	17	17	9.9	41.5	47.7	20.5	12	14	9.9	50
SPUM 08	8	8	14.4	18.5	18.5	10.6	47.2	53.4	23	14	16	15.9	50
SPUM 10	10	10	17.6	21	21	11.3	52.9	59.9	29	17	19	27.7	50
SPUM 12	12	12	21.2	22	22	10.5	63.3	70.9	32	21	23	35.5	25

MODEL[ØD-T] Tube(Metric)-Thread(R)

MODEL	ØD	C1	C2	ØP	B	W.G(g)	Qty/Inbox
SPU 04	4	16	16	10	42.9	6.6	50
SPU 06	6	17	17	12.4	46.9	8.2	50
SPU 08	8	18.5	18.5	14.4	52.6	12.7	50
SPU 10	10	21	21	17.6	59.2	22.9	50
SPU 12	12	22	22	21.2	71.8	36.8	25

SPU
Union Straight

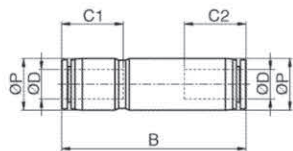

SPL
Elbow

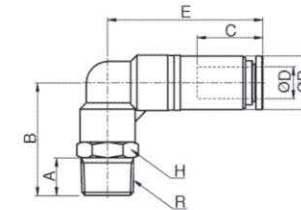

MODEL[ØD-T] Tube(Metric)-Thread(R)

MODEL	ØD	R	C	E	ØP	B	H	A	W.G(g)	Qty/Inbox
SPL 04-M5	4	M5	16	30.7	10	22.1	10	5.5	15.9	100
SPL 04-M6	4	M6	16	30.7	10	22.1	10	5.5	15.9	100
SPL 04-01	4	R1/8	16	30.7	10	24.6	10	8	19.7	50
SPL 06-M5	6	M5	17	31.9	12.8	22.6	12	8.5	20.1	100
SPL 06-01	6	R1/8	17	31.9	12.8	24	12	8	20.5	50
SPL 06-02	6	R1/4	17	31.9	12.8	28	14	11	30.6	50
SPL 08-01	8	R1/8	18.5	40.8	14.4	27	14	8	32	50
SPL 08-02	8	R1/4	18.5	40.8	14.4	31	14	11	39.2	50
SPL 08-03	8	R3/8	18.5	40.8	14.4	32	17	12	48.8	50
SPL 10-02	10	R1/4	21	47.6	17.6	35	17	11	56.2	25
SPL 10-03	10	R3/8	21	47.6	17.6	36	17	12	65.9	25
SPL 10-04	10	R1/2	21	47.6	17.6	39	21	15	89.5	25
SPL 12-03	12	R3/8	22	55.5	21	38	21	12	83.7	25
SPL 12-04	12	R1/2	22	55.5	21	41	21	15	106.6	25

Metric Size G(PF) Thread Type

- One -Touch Fittings
- Compact One -Touch Fittings
- Speed Controllers
- Metal Body Speed Controllers
- Rotary Joints
- **Stop Fittings**
- Check Valves
- Ball Valves
- Hand Valves

STOP FITTINGS

Application

- Installed where the pneumatic connections are changed frequently.
- Used at laboratory or for instructing pneumatic connections.

Feature

- Upon disconnecting the tube, the airflow will stop.

Specification

Fluid	Air(No other gases or liquids)	
Working Pressure Range	0~150PSI	0~9Kgf/cm ² (0~900kPa)
Negative Pressure	-29.50 in Hg	-750mmHg(10Torr)
Temperature Range	32~140° F	0~60° C
Applicable Tube Material	Polyurethane and Nylon	

Structural Diagram

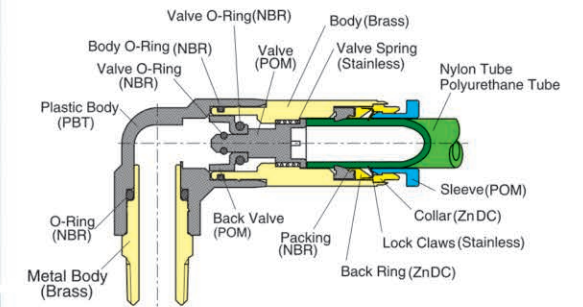

Control Method

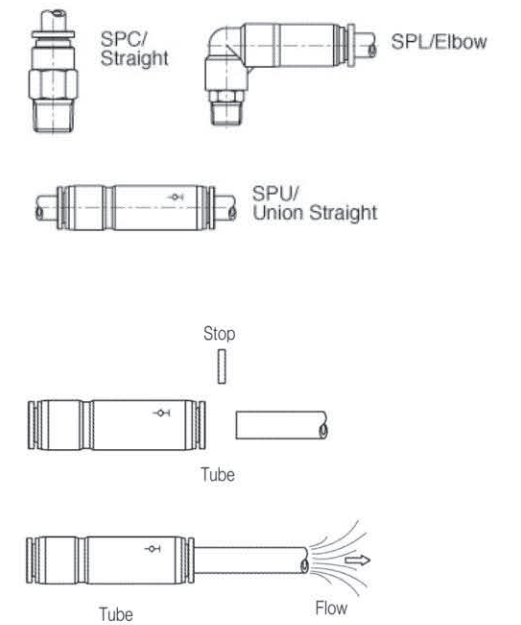

Product Code System

SPC 06-G01

① Type	② Tube Dia(∅D)	③ Thread Size(T)
Code	04 06 08 10 12	Metric Size Taper Pipe Thread
Dia	∅4 ∅6 ∅8 ∅10 ∅12	Code M5 M6 G 01 G02 G03 G04
		Size M5 × 0.8 M6 × 1.0 R1/8 R1/4 R3/8 R1/2

CAUTION

- Be sure to read the "Common Precautions" and "Using Precautions of Fitting Series"(P12) before using.
- Be sure to confirm the direction of the stop instrument.

WARNING

- Be careful of spring-up of the tube in case of disconnection when the pressure is on in the stop fitting.

SPC-G
Straight

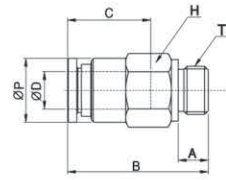

MODEL[ØD-T] Tube(Metric)-Thread(G)

MODEL	ØD	R	H	C	ØP	B	A	W.G(g)	Qty/ Inbox
SPC 04-G01	4	G1/8	14	16	10	26.6	6	10.5	100
SPC 06-G01	6	G1/8	14	17	12	26.9	6	12.7	100
SPC 06-G02	6	G1/4	17	17	13	29.4	8	21.3	50
SPC 08-G01	8	G1/8	17	18.5	14	31.8	8	24	50
SPC 08-G02	8	G1/4	17	18.5	14	33.8	8	20.4	50
SPC 08-G03	8	G3/8	21	18.5	17	33.8	10	38.7	50
SPC 10-G02	10	G1/4	17	21	17	37.3	8	29.4	50
SPC 10-G03	10	G3/8	21	21	17	38.3	10	34.3	50
SPC 10-G04	10	G1/2	24	21	18	38.3	12	61	50
SPC 12-G03	12	G3/8	21	22	20.2	46	10	58.8	25
SPC 12-G04	12	G1/2	24	22	20.2	49	12	66.9	25

SPL-G
Elbow

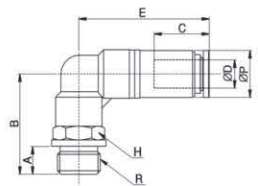

MODEL[ØD-T] Tube(Metric)-Thread(G)

MODEL	ØD	R	C	E	ØP	B	H	A	W.G(g)	Qty/ Inbox
SPL 04-G01	4	G1/8	16	30.7	10	25.6	10	6	19.7	50
SPL 06-G01	6	G1/8	17	31.9	12.8	25	12	6	20.5	50
SPL 06-G02	6	G1/4	17	31.9	12.8	28	14	6	30.6	50
SPL 08-G01	8	G1/8	18.5	40.8	14.4	27	14	8	32	50
SPL 08-G02	8	G1/4	18.5	40.8	14.4	31	14	8	39.2	50
SPL 08-G03	8	G3/8	18.5	40.8	14.4	34	17	10	48.8	50
SPL 10-G02	10	G1/4	21	47.6	17.6	35	17	8	56.2	25
SPL 10-G03	10	G3/8	21	47.6	17.6	38	17	10	65.9	25
SPL 10-G04	10	G1/2	21	47.6	17.6	40	19	12	89.5	25
SPL 12-G03	12	G3/8	22	55.5	21	38.9	21	10	83.7	25
SPL 12-G04	12	G1/2	22	55.5	21	41.9	21	12	106.6	25