



Level or level and temperature sensor NV 73

- flange according to DIN 24557 part 2
- qualified breather with replaceable element
- visual surveillance of breather optional
- continuous level measurement
- continuous level and temperature measurement
- 4-20 mA outputs (2-10 V on request)
- resolution 5 mm (level)
- various connector options
- reliable, dynamic float system
- float and probe in stainless steel optional
- probe length up to 1420 mm (longer on request)

Technical data

NV 73

Basic units

K = continuous level and temperature measurement
KN = continuous level measurement

operating pressure max. 1 bar
 operating temperature -20 °C to +80 °C
 min. spec. density of fluid 0,80 kg/dm³ float SK 604
 0,85 kg/dm³ float SK 221
 Lengths (L=) 280, 370, 500, 670, 820, 970
 1120, 1270 und 1420 mm
 (on request other lengths)

Breather HY Type Hydac BF 7
 grade of filter 3 µm
 Accessories filling protective cover
 - not applicable for filling adapter -

Material / Design	MS	VA*
float	hard PU SK 604	1.4571 SK 221
immersion tube	brass	1.4571
flange / filter housing	PA	PA
stilling tube (option)	brass	VA

* not available in combination with option FCT

Level measurement

measuring resistor reed contact
 resolution 5 mm
 supply voltage (U_B) 10 - 30 V
 ripple < 1 %
 output signal 4-20 mA
 load Ω max. (U_B - 7,5 V) / 0,02 A

Temperature measurement at Type 73 K

measuring resistor Pt 100
 class B DIN EN 60 751
 tolerance ± 0,8 °C
 supply voltage (U_B) 10 - 30 V
 ripple < 1 %
 output signal 4-20 mA (≈ 0-100 °C**)
 load Ω max. (U_B - 7,5 V) / 0,02 A
 ** on request other areas

included in the delivery

fixing bolts (6 pieces) and GI -cork gasket

Flange picture

according to DIN 24557/part2

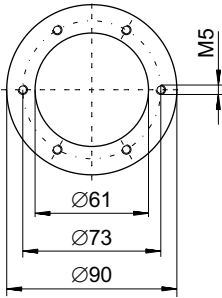

Float SK 604 for NV 73-MS

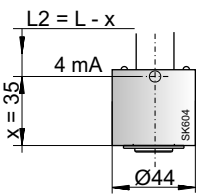

Float SK 221 for NV 73-VA

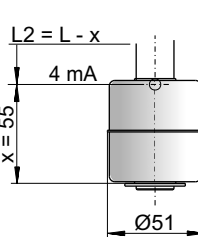

Basic version

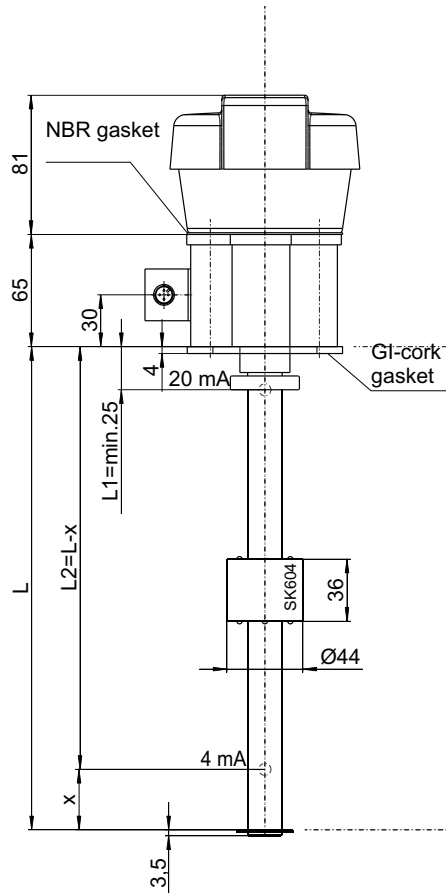

Design with options

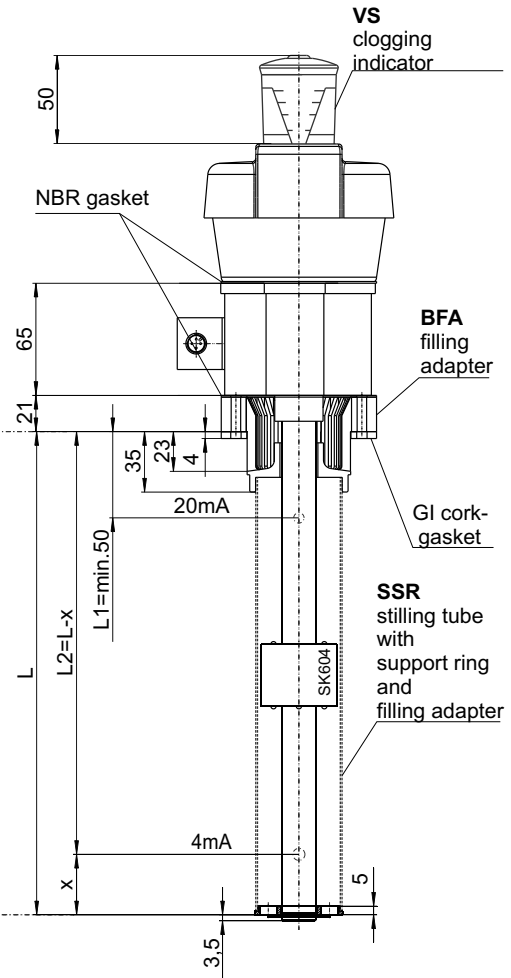

Options / Accessories

- VS** clogging indicator visual for the breather: analogue underpressure indicator, display range 0,35 bar.
- BFA*** filling adapter incl. ribbed flange with sieve insert: this option allows that small oil quantities can be filled via the breather housing. Therefore the corresponding housing is equipped in that version.
- SSR*** stilling tube with support ring and filling adapter: This includes the option stilling tube as well as the option for filling as the **BFA**. The stilling tube is made of the same material as the requested immersion tube (MS/VA).
- MT** for integration into Multiterminal: The basic unit will be mounted to the Multiterminal. For specification we refer to data sheet DE 10 0201.
- MTS** for integration into Multiterminal including stilling tube: in addition to the basic unit, a stilling tube with support ring is mounted to the Multiterminal.
- FCT** Fluidcontrolterminal: The Fluidcontrolterminal (**FCT**) will be mounted to the basic product. For specification we refer to data sheet DD 10 0202.

Optionally, a programmable display and control unit is available which can show and monitor the measurement, see data sheet DE 18 0201.

* not available in combination with option **FCT** and **MT/MTS**

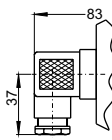
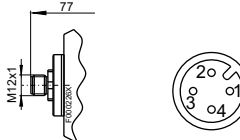
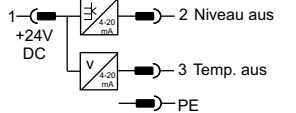
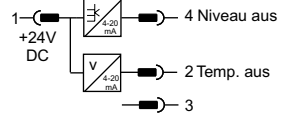
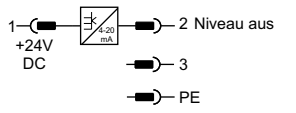
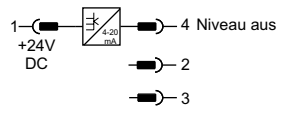
Connector protection system cable connection	M3 (DIN EN 175301-803) 3 pol. + PE IP 65 PG 11	M12 (base) 4 pol. IP67** **with casted connector head
Standard pin assignment		
K continuous level and temperature measurement		
KN continuous level measurement		

Product code for NV 73

NV 73-HY-

Series

Nivovent **NV 73-HY**

K = Level and temperature measurement
KN = only level measurement

Design

MS brass
VA* float and immersion tube VA

Connector

M3
M12

Length (max. 1420 mm)

280
370
500
670
820
970
1120
1270
1420

Optionen / Zubehör

BFA** = filling adapter
SSR** = stilling tube with filling adapter
MT = for Multiterminal
MTS = for Multiterminal incl.
 stilling tube
FCT = Fluidcontrolterminal

VS = clogging indicator

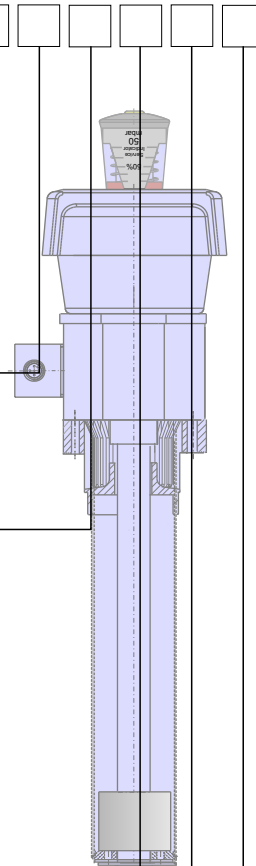

* not available in combination with option FCT

** not available in combination with option FCT, MT and MTS

Accessories:

Part No.	Description
91 44 05 0010	Connecting cable M12x1, 4-pol., 1,5 m, elbow connector (female) and straight connector (male)
91 44 05 0046	Connecting cable M12x1, 4-pol., 3,0 m, elbow connector (female) and straight connector (male)
91 44 05 0047	Connecting cable M12x1, 4-pol., 5,0 m, elbow connector (female) and wire

Furthermore a programmable display and control unit is available which can show and monitor the measurement, see data sheet DE 18 0201.

Example for order

You need: Level and temperature measurement with breather, resolution 5 mm, brass Design with M12 connector and a length L = 670 mm

You order: NV 73-HY-K-MS-M12 / 670