



## 특징 (Character)

- RACK & PINION을 사용한 광각형 각도개폐방식  
Angular type by Rack & Pinion driving unit
- 개폐범위가 180도로 제품 파지시 간섭배제가 가능  
Allow to grip the workpiece by open-close range 180° without any interference
- 개폐검출 센서 전기종 부착가능  
Magnetic sensor is available for open-close sensing



## 랙 & 피니언 방식 (Rack & pinion type)

### 작동 방식 (Kinetics)

랙 & 피니언 방식  
pinion and toothed rack  
system, centric gripping

### 조 (Jaws)

파지부  
for gripping

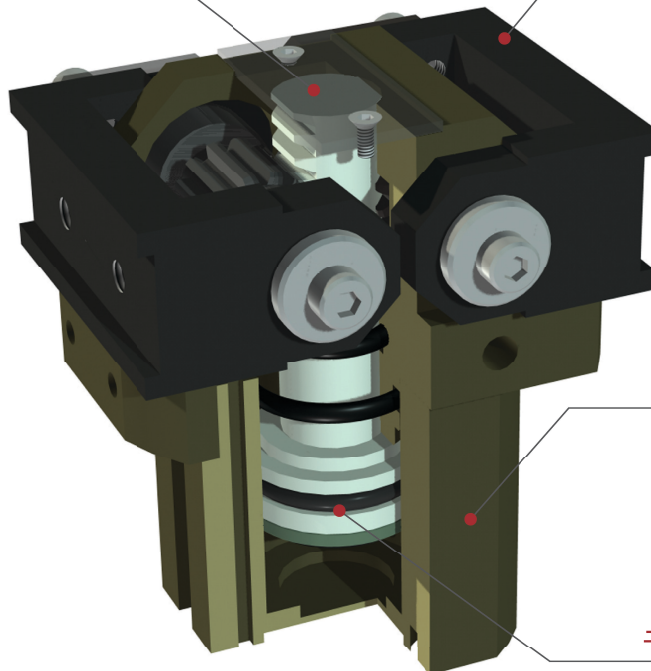

### 몸체 (Body)

경질 처리된 경량의  
알루미늄 합금  
aluminum body with  
st possible because of  
hard anodizing

### 구동부 (Drive)

복동식  
double acting  
pneumatic cylinder

부품분해도 ( Exploded view )

※ 본 분해도는 한 제품을 예시하였으므로 기종별로 차이가 있을 수 있습니다  
 ※ This is exploded view illustrates a certain product only. The contents may vary by product models.

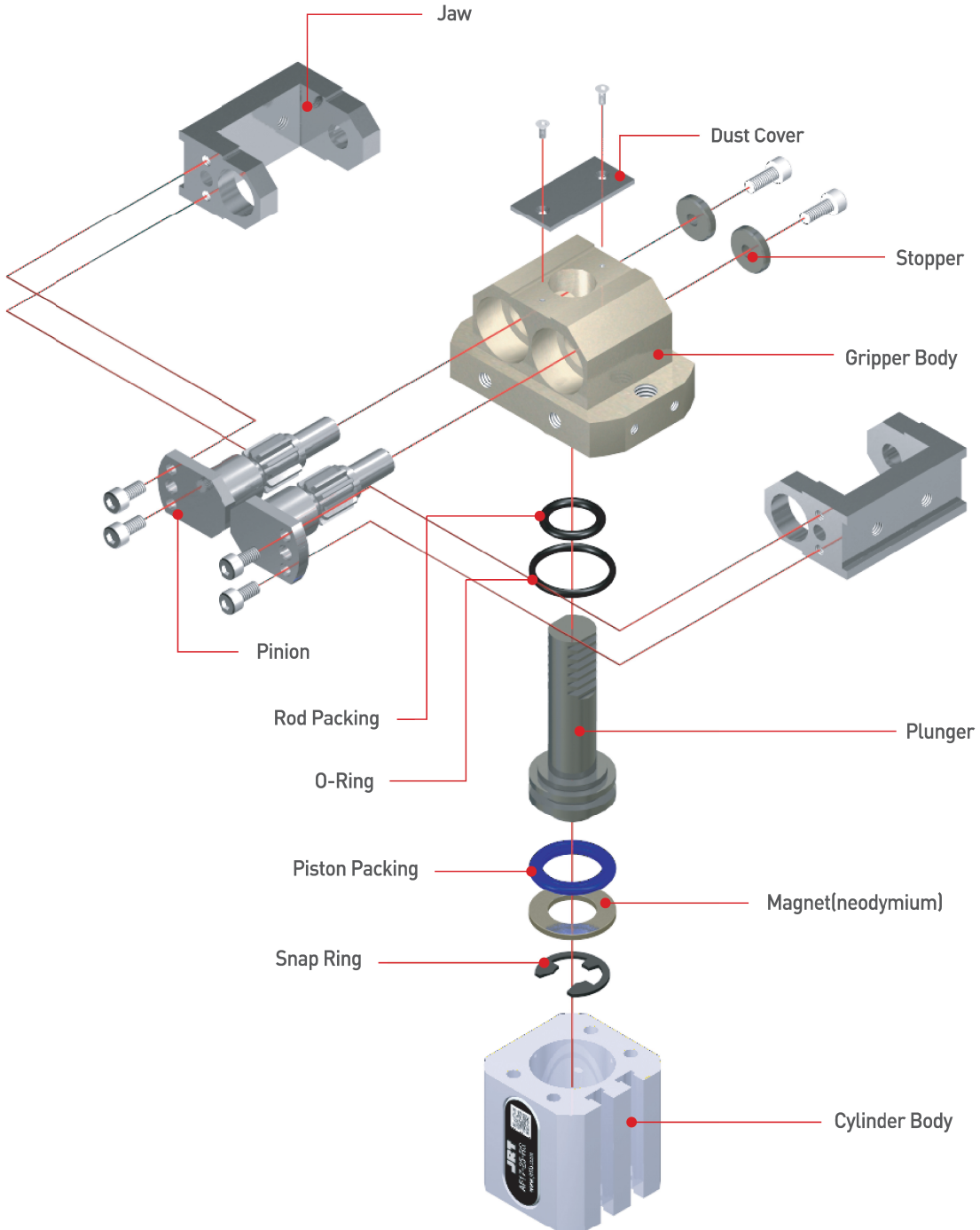

AF101
AF02
AF04P
AF105P
AF10
AF13
AF14
AF15
AF316
AF316L
AF416
<b>AF17</b>
AF117
AF24
AF26
AF28D
AF28DS
AF30
AF30L
AF46
AF56L
RAF56N
MF16
JPGB
JEGG
JEGB
JEGC
JEGD
JVGE

주문기호 ( How to Order )

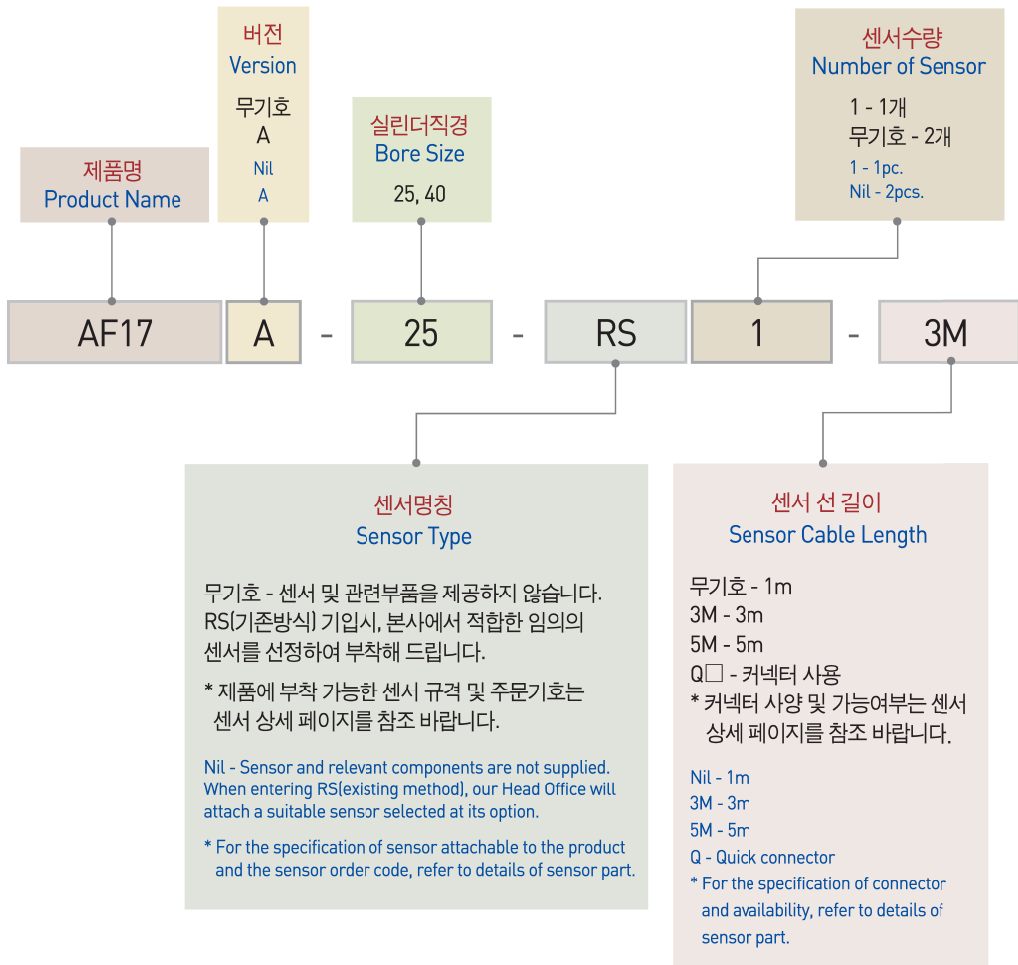

## ☐ 제품사양 ( Specification )

P=공기압력(bar), L=작용점까지의 거리(mm)  
P = Air Pressure(bar), L = Gripping point distance(mm)

제품명칭 Products Name	AF17A-25	AF17-40	단위 Unit
개폐범위 Stroke	0 to 180	0 to 180	degree
제품중량 Weight	0.68	0.86	kg
최대치구길이 Max. length attach	50	50	mm
배관접속구 Fitting size	M5	PF(G) 1/8	
파지력 : 열림시 Gripping force : Open	22.56P/0.1L	51.01P/0.1L	N
파지력 : 닫힘시 Gripping force : Close	15.70P/0.1L	38.26P/0.1L	N
1사이클당 공기소모량 Air consumption per cycle	8.3	21.2	cm <sup>3</sup>
닫힘시/열림시 시간 Closing / Opening time	0.01/0.01	0.01/0.02	sec
반복정밀도 Repeat accuracy	0.2	0.2	mm
연속사용회수 Continuation usage amount	60	60	cpm
사용압력 Operating pressure	3~7		bar
주위온도 Ambient temperature	-5 to 60		℃
윤활 Lubrication	불필요 Needless		

반복정밀도 : 연속 100회 작동후 측정치  
After 100 consecutive strokes to end positions

## ☐ 작용점에서의 파지력 ( Gripping Force From a Point of Action )

범례( Legend ) : —■ 7[bar] —■ 5[bar] —■ 3[bar]

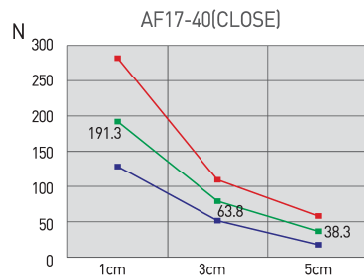
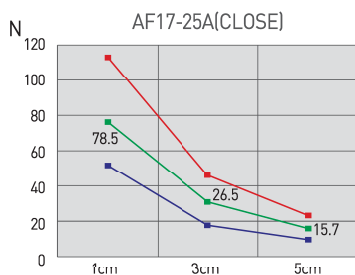
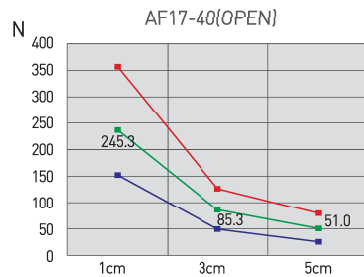
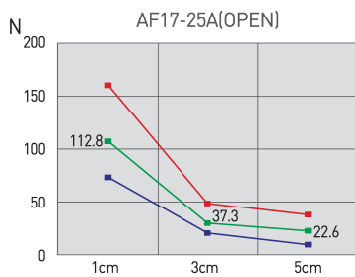

- AF101
- AF02
- AF04P
- AF105P
- AF10
- AF13
- AF14
- AF15
- AF316
- AF316L
- AF416
- AF17**
- AF117
- AF24
- AF26
- AF28D
- AF28DS
- AF30
- AF30L
- AF46
- AF56L
- RAF56N
- MF16
- JPGB
- JEGG
- JEGB
- JEGC
- JEGD
- JVGE

AF17A-25

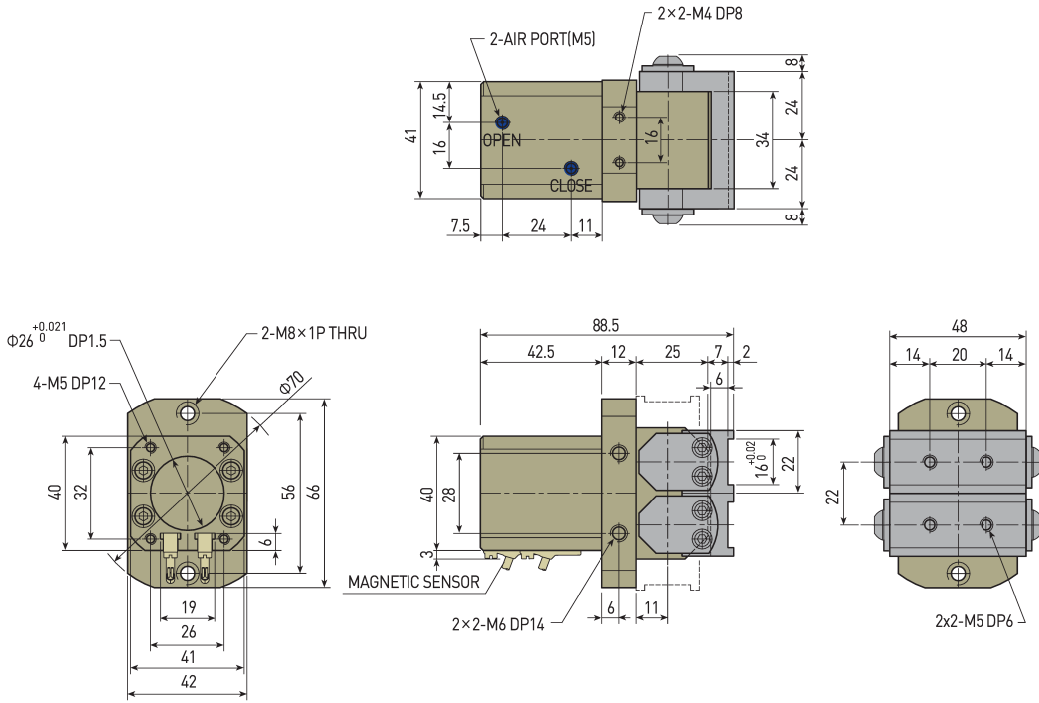

AF17-40

